

Permit Set	
Job # 24-028	
Description	Date
Permit Intake	10/07/24
Correction 01	02/04/25
Correction 02	03/06/25
Resubmittal	11/10/25

Permit No. 2510-181  
Drawn:  
Stamp/Approval:

Sheet Name:

**SITE CALCULATIONS**

Sheet No:

**T4.0B**

**SITE LOT AREA**  
LOT AREA: (0.58 ACRES) 25,059 S.F.

**SITE AREA CALCULATIONS**  
TOTAL LOT AREA - 25,059 SF  
EXISTING HOUSE ROOF - 2,493 SF  
EXISTING ACCESSORY BUILDING ROOF AREA - 2,449 SF  
EXISTING DRIVEWAY - 2,113 SF  
EXISTING CONCRETE WALKWAYS/PATIO - 2,010 SF  
PROPOSED ROOF ADDITION (REPLACED IMPERVIOUS) - 479 SF  
  
TOTAL EXISTING IMPERVIOUS - 9,065 SF  
TOTAL PROPOSED REPLACED IMPERVIOUS - 479 SF  
NET INCREASE IMPERVIOUS SURFACES - 0 SF  
TOTAL IMPERVIOUS (EXISTING/PROPOSED) AFTER PROJECT COMPLETION - 9,065 SF

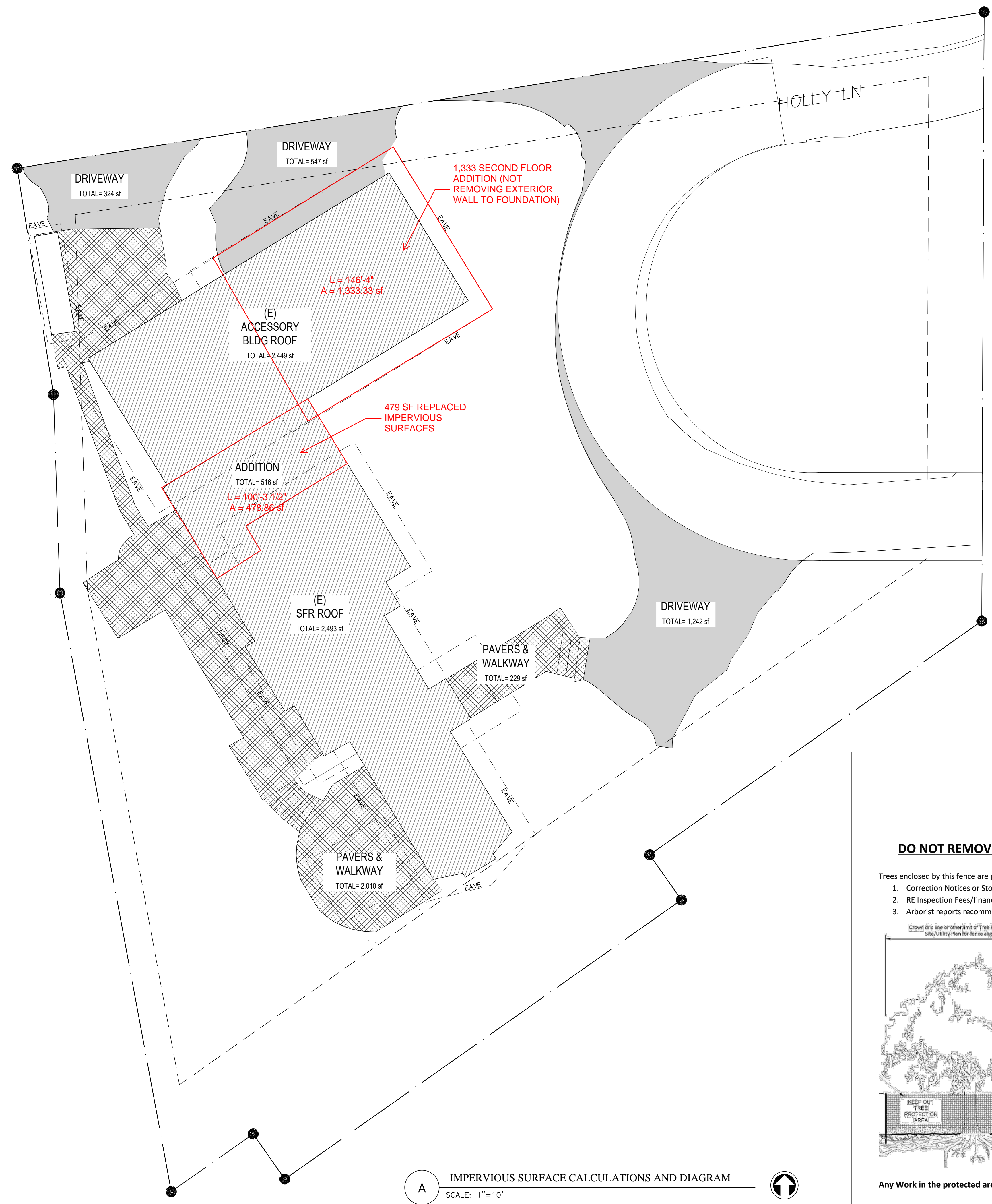

**A IMPERVIOUS SURFACE CALCULATIONS AND DIAGRAM**  
SCALE: 1"=10'  
NORTH

**TREE PROTECTION AREA (TPZ)  
KEEP OUT!**

**DO NOT REMOVE OR ADJUST THE APPROVED LOCATION OF THIS TREE PROTECTION AREA**

Trees enclosed by this fence are protected and are subject to the conditions of the tree permit. Violation of tree conditions may lead to:

1. Correction Notices or Stop Work Orders until compliance is achieved
2. RE Inspection Fees/financial penalties
3. Arborist reports recommending mitigation

- Notes
1. No pruning shall be performed unless under the direction of the Project Arborist. Including limbing trees up.
  2. No grading, excavation, storage (materials, equipment, vehicles, etc.), or other unpermitted activity shall occur inside the protective fencing.
  3. Penalties for damaging by root damage/compaction or removing a saved tree may be a fine up to three times the value of the tree plus restoration (MICC 19.10.160).
  4. Any work in approved TPZ must be with the permission of the Land Use and Planning Division at [landuse.planning@mercergov.org](mailto:landuse.planning@mercergov.org)
  5. 5" course woodchips within the tree protection zone, but not against the tree trunk.

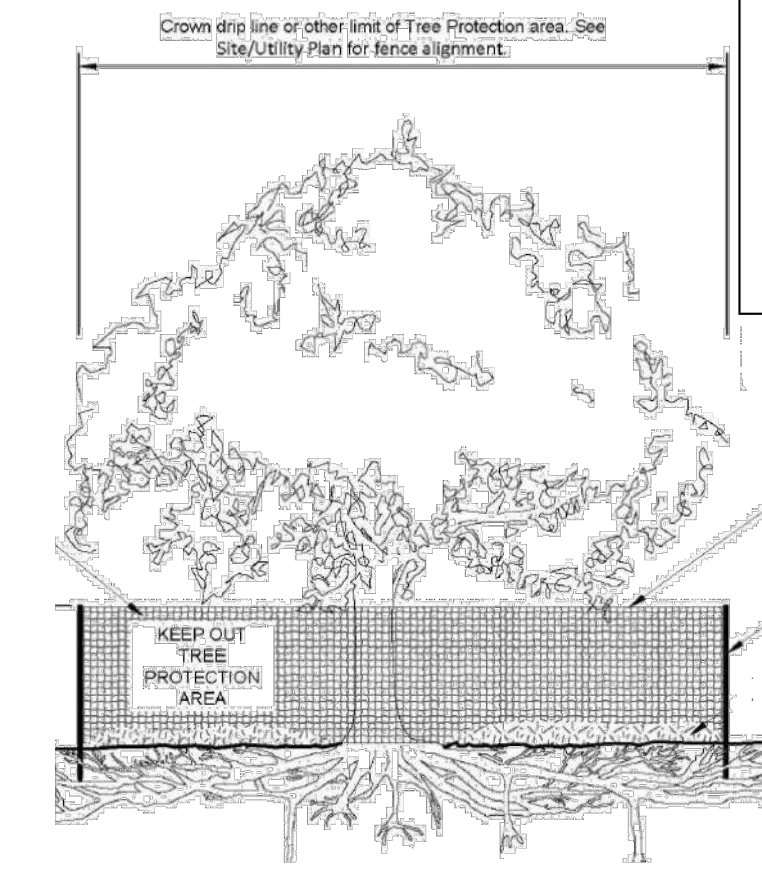

Tree protection fence: 4-6" chain link fence, solidly anchored into the ground, or if authorized High-density polyethylene fencing with 3.5" x 1.5" openings; color orange. Steel posts installed at 8' o.c.

2" x 6" steel posts or approved equal

Maintain existing grade with the tree protection fence unless otherwise indication on the plans

Any Work in the protected area must be with the permission of the Land Use and Planning Division at [landuse.planning@mercergov.org](mailto:landuse.planning@mercergov.org)